

PRECAST FACADE



FACTORY

PLANT PRECAST CIBITUNG

Jl. Imam Bonjol, Desa Telaga Asih
Cibitung - Bekasi
T. 021.8836.2536 - 8836.2537
F. 021.8836.2531

PLANT PRECAST CIKARANG

Jl. Raya Industri, Tegal Gede Pasir Sari
Cikarang Selatan
T. 021.893.6722

PLANT PRECAST KARAWANG

Desa Purwasari, Kec. Purwasari &
Desa Dawuan Barat, Kec. Cikampek
Kab. Karawang

PLANT PRECAST SURABAYA

Jl. Tambak Osowilangun 7E
Kota Surabaya
T. 031.749.4311
F. 031.748.2229

PLANT PRECAST MANYAR

Kawasan Industri Manyar - JIPE
Jl. Industri Manyar Km.11, Manyarejo
Manyar - Gresik

HEAD OFFICE

L'AVENUE Office Tower Lt. 25
Jl. Raya Pasar Minggu Kav. 16, Pancoran, Jakarta 12780
T. +62.21.799.4666 F. +62.21.799.1666

OPERATION OFFICE

Jl. Imam Bonjol, Ds. Telaga Asih, Cibitung - Bekasi
T. 021.8836.2536 - 37 F. 021.8836.2531

www.adhimix.co.id



PRECAST FACADE

DEFINITION

FACADE is an exterior building, an architectural wall panel and not designed as a structural panel (non load bearing wall).

TECHNICAL SPECIFICATION

- Type : Precast
- Concrete Strength : f_c 29 Mpa (K350)
- Slump : 12 + 2 cm
- Dimension : Wide following architectural design
Height follows the structure's elevation
Thickness 80-10 cm
- Rebar : Wiremesh M-6, 1 layer
- Joint Connection : Welded (facade panel - joint plate "L")
Mechanical anchor (joint plate "L" - structure)
- Structure perimeter: 30 mm

FLAT TYPE

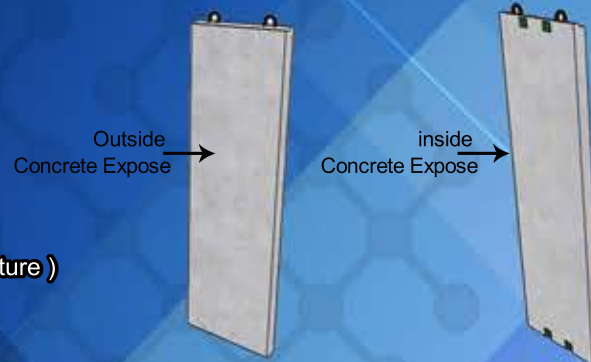

L TYPE

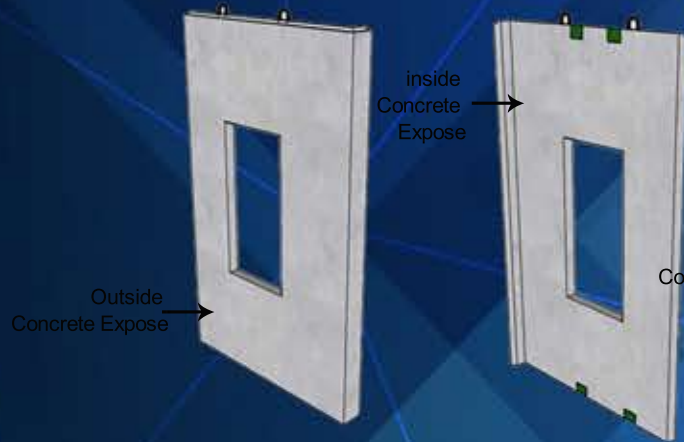

OPENING TYPE

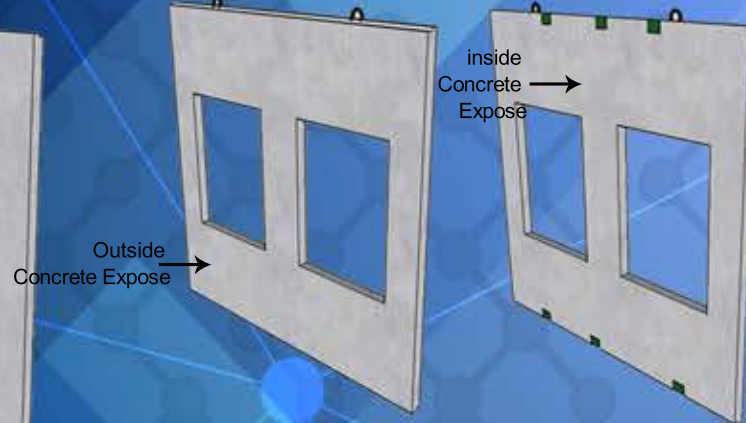

APPLICATION

- Apartement
- Mall
- Office Building
- Hospital
- And other



PRINCIPAL DESIGN

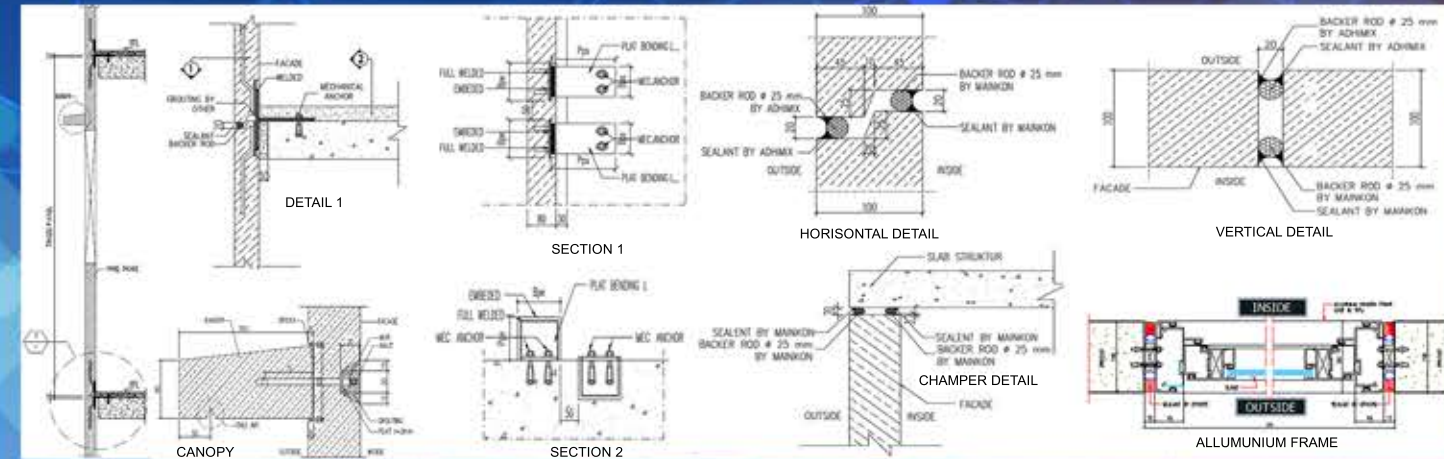

Material Specifications :

Concrete

No	Item	Reference	Description	Specification
1	Agregate	ASTM C33 - 1999	Standard Specification for Concrete Aggregate	Standar produk type I
2	Cement	SNI 15 - 2049 - 2004	Portland Cement	Type F : Water Reducing admixture
3	Admixture	ASTM C494 - 1985	Standard Specification for Chemical Admixture for Concrete	

Rebar

No	Item	Reference	Description	Specification
1	Wiremesh	SNI 2052 - 2018	Baja Tulangan Beton Bertulang	Yield Strength (fy) minimum 500 Mpa
2	Tulangan Ulir	SNI 2052 - 2018	Baja Tulangan Beton Bertulang	Yield Strength (fy) minimum 420 Mpa
3	Tulangan Polos	SNI 2052 - 2018	Baja Tulangan Beton Bertulang	Yield Strength (fy) minimum 240 Mpa

Joint

No	Item	Reference	Description	Specification
1	Welding	AWS D1.1 - 1990	Structural Welding Code - Steel	AWS A S1 / E 60.13
2	Mechanical Anchor	Fastenc Wedge Anchor		

Gap Fill

No	Item	Reference
1	Poly Uretane Sealant	SikaHyflex-140 Façade
2	Backer Rod	

